

Dimensional Data (inches and [ mm ]) are Subject to Manufacturing Tolerances and Change Without Notice

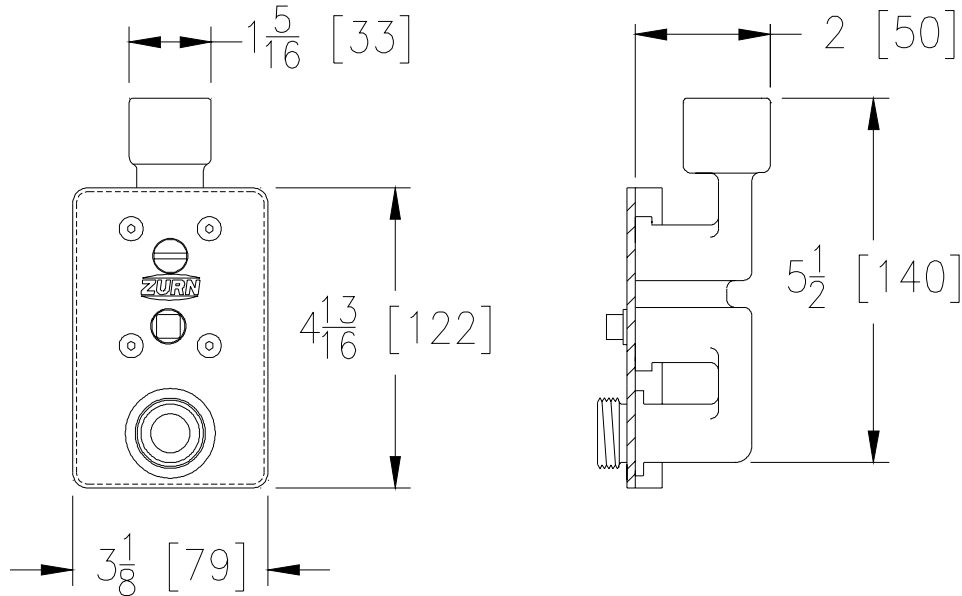

Wall Thickness In Inches	Approx. Wt. Lbs. [kg]
N/A	2 [1]

**ENGINEERING SPECIFICATION:** Z1349 Exposed moderate climate, wall hydrant for narrow wall installation, complete with bronze body, all bronze interior parts, replaceable seat washer, screwdriver-operated stop valve in supply, key-operated control valve, 3/4 [19] female IP inlet connection standard, and 3/4 [19] male hose connection. Includes operating key.

**OPTIONS** (Check/specify appropriate options)

**SUFFIXES**

- \_\_\_ -34FS 3/4 [19] Female Solder Inlet Adapter
- \_\_\_ -34UN 3/4 [19] IP 90° Inlet Elbow with Union Nut
- \_\_\_ -VB 3/4 [19] Adapter Vacuum Breaker
- \_\_\_ -RK Hydrant Parts Repair Kit