



# Z1723

## 4 X 12 [102 X 305] GUTTER DRAIN

SPECIFICATION SHEET

TAG \_\_\_\_\_

Dimensional Data (inches and [ mm ]) are Subject to Manufacturing Tolerances and Change Without Notice

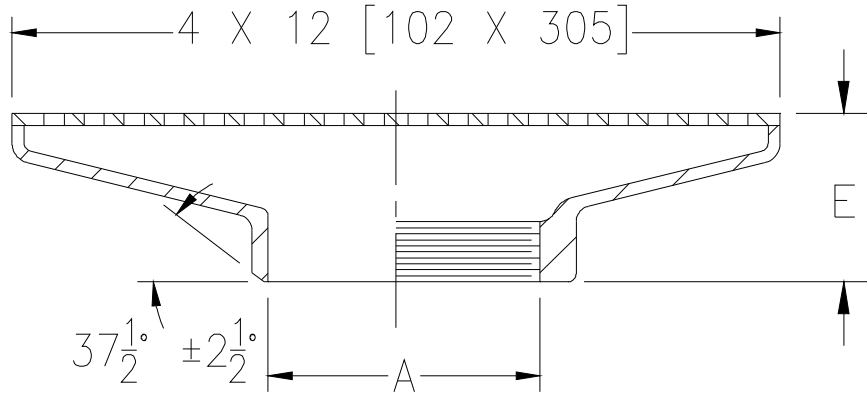

A Pipe Size	Approx. Wt. Lbs. [kg]	Grate Open Area Sq. In. [cm <sup>2</sup> ]
2-3-4[52-76-102]	10 [4.5]	18 [116]

**ENGINEERING SPECIFICATION: ZURNZ1723**  
 4 x 12 [102 x 305] Gutter drain all Type 304 (CF8) stainless steel body and secured grate with plain finish.

**OPTIONS** (Check/specify appropriate options)

PIPE SIZE	(Specify size/type)	OUTLET	'E' BODY HT. DIM.
2-3 [52-76]	___ BW	Butt-weld (Specify Schedule 10, 40 or 80)	2-5/8 [67]
2-3 [52-76]	___ IP	Threaded	2-5/8 [67]
4 [102]	___ IP	Threaded	4 [102]

**PREFIXES**

- \_\_\_ Z Type 304 (CF8) Stainless Steel Body\*
- \_\_\_ ZM Type 316 (CF8M) Stainless Steel Body

**SUFFIXES**

- \_\_\_ -SF Satin Finish Top
- \_\_\_ -VP Vandal-Proof Secured Top

REV. D	DATE: 11/15/10	C.N. NO. 120386
DWG. NO. 59291	PRODUCT NO. Z1723	

\*REGULARLY FURNISHED UNLESS OTHERWISE SPECIFIED