

PROJECT NAME: _____

LOCATION: _____

SPECIFIER ITEM NO. _____ **QTY:** _____

ENCORE PART NO. _____

Encore[®] Low Lead 4" (102mm) Wall Mount
 Faucet with 3-1/2" (89mm) Swivel Gooseneck
 Spout, 0.5gpm PCA Spray Aerator and
 4" (102mm) Wrist Blade Handles

KL45-4x00-SC4 Series

KL45-4000-SC4 3" Spout, Ceramic Valves
 KL45-4100-SC4 3" Spout, Compression Valves

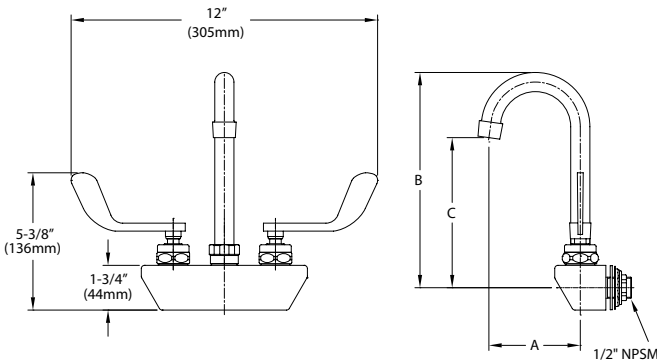

Dimensions shown in inches (mm) are for reference only
 and are subject to change.

1/2" NPSM Male Inlets
 Operating Temperature: 40-180°F (5-83°C)
 Operating Pressure: 15-125psi
 Note: 1-1/8" (29mm) holes for backsplash are
 recommended to accommodate 1/2" supply nipples

* KL Series low lead faucets are NSF annex G approved.

Approximate shipping weight - 5 lbs
 Warranty - 2 years parts

Solid heavy duty low lead cast body is specification and commercial
 quality for hand sinks.

Commercial Quality Features

- 3-1/2" (89mm) Swivel gooseneck spout design
- ADA-compliant 4" (102mm) wrist blade handles
- Built-in check valves to prevent cross-flow and back-flow
- Leak proof double O-ring spout design

SANIGUARD[®] Product Protection

- Permanently incorporated on all touch points of Encore plumbing fixtures
- Inorganic, silver ion technology inhibits growth of common bacteria, yeasts, mold and fungi, minimizes cross-contamination

SPECIFICATIONS:

Low Lead Wall Mount Faucet to be Encore KL45-4000-SC4 Series
 in the following configuration:

- _____ KL45-4000-SC4 3" Spout, Compression Valves
- _____ KL45-4100-SC4 3" Spout, Ceramic Valves

Faucet body to be constructed of polished chrome plated brass with total
 lead content less than 0.25% by weighted average. Handles to be 4" wrist
 blade and incorporated with SANIGUARD treatment. Supply inlets to be 4"
 on center. Valves to be 1/4-turn with integral check valve to prevent cross-
 flow and back-flow. Spout to be 3-1/2" swivel gooseneck style with leak proof
 double O-ring seal design. Color coded temperature indexes shall meet
 international standards. 0.5gpm PCA spray aerator @ 60psi standard with
 full flow stream bubbler screen spout tip.

Model No.	A	B	C
KL45-4000-SC4	3-1/2" (89mm)	8-3/16" (208mm)	5-15/16" (151mm)
KL45-4100-SC4	3-1/2" (89mm)	8-3/16" (208mm)	5-15/16" (151mm)

For a complete list of available options for KL45-4000 Series,
 see product configurator on reverse.

COMPLIES WITH:
 ASME A112.18.1-2005
 CSA B125.1-05
 NSF/ANSI 61/9, ANNEX G
 SECTION 116875 OF THE
 CALIFORNIA HEALTH & SAFETY CODE
 (COMMONLY KNOWN AS AB1953)
 VERMONT ACT 193
 UNIFORM PLUMBING CODE



Faucet Configuration for KL45-4x00-SC4 Series

