



Buy Factory Direct and Save



STHK595 Powers* 900* Cartridge 900-031*

Installation Instructions

GENERAL INSTRUCTIONS

- 1) TURN OFF WATER TO VALVE OR TURN OFF INTEGRAL STOP IF VALVE SO EQUIPPED.
- 2) TURN ON VALVE ALLOWING WATER TO DRAIN OUT.
- 3) REMOVE HANDLE AND COVER PLATE, EXPOSING VALVE BODY.
- 4) REMOVE RETAINING NUTS AND LIMIT STOPS
- 5) UNSCREW AND/OR PULL OUT UPPER CARTRIDGE ASSEMBLY.
- 6) PULL OUT LOWER CARTRIDGE ASSEMBLY USING PULLER TOOL (IF PROVIDED)
- 7) CLEAN BODY AND ALL SEAL SURFACES THOROUGHLY.
- 8) REINSTALL IN REVERSE ORDER, USING NEW PARTS PROVIDED
NOTE: SOME KITS CONTAIN PARTS FOR MORE THAN ONE MODEL. DISCARD AS APPROPRIATE.
- 9) TIGHTEN ALL SCREWS AND FITTINGS BUT DO NOT OVER TIGHTEN.
- 10) TURN ON WATER AND TEST.
- 11) FOR ERRATIC SHOWER SPRAY, CLEAN OR REPLACE SHOWER HEAD.
- 12) SEE BELOW FOR MORE DETAILS.

Figure 1: Stem Position Information

FOR REVERSED INLETS
COLD WATER
INTO
HOT PORT:

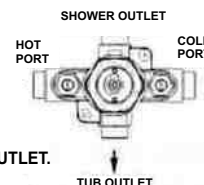

1. "TOP" STAMPED ON STEM FACES TUB OUTLET.
2. FLATS ON STEM MUST FACE TOP AND BOTTOM OUTLETS.

FOR STANDARD INLETS
COLD WATER
INTO
COLD PORT:

1. "TOP" STAMPED ON STEM FACES TUB OUTLET.
2. FLATS ON STEM MUST FACE TOP AND BOTTOM OUTLETS.

Figure 2

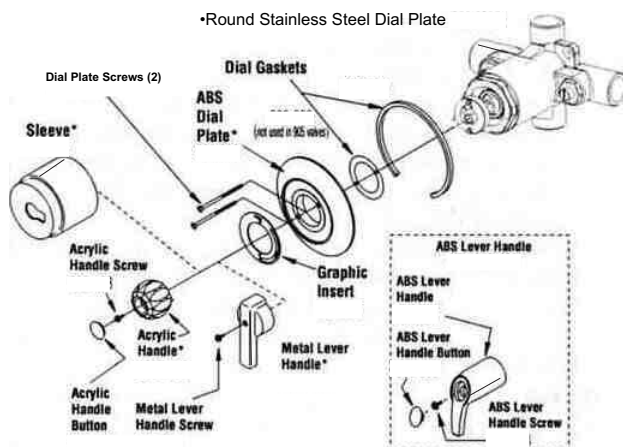

REPAIR KITS

For further information on repair and maintenance

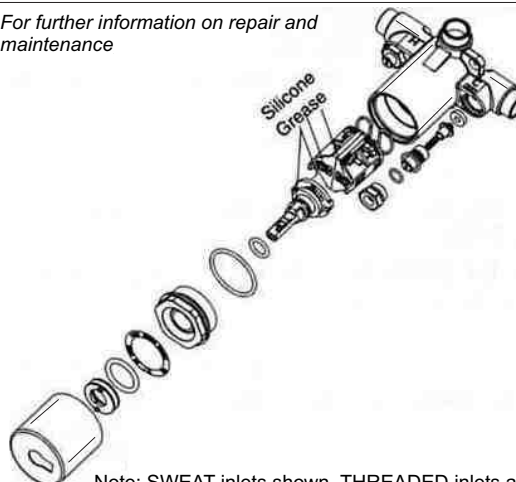

Note: SWEAT inlets shown. THREADED inlets also available.

Note: For valves sold without checkstops, it is recommended that the valve be installed where there is shut-off upstream of the valve, so that the valve may be easily serviced and accessed. If this is not possible, the valve should include a shutoff or combination checkstop/shutoff on the inlets.

Description	Troubleshooting
Gasket and Disc Replacement	<ul style="list-style-type: none"> * Water leaks at valve stem and/or bonnet. * Water leaks at valve shut-off. * Water leaks at checkstop.
Internals Replacement	* With mixer handle in MID position, HW flows with CW checkstop closed or CW flows with HW checkstop closed.
Checkstop Replacement	* Checkstop will not completely shut off.

Factory Direct Supply Company

(855)289-8721 Toll Free Number

www.fdsupply.com

* REGISTERED/NON REGISTERED TRADEMARK OR TRADE NAME OF THE FAUCET OR MANUFACTURER THAT ACCEPTS THIS PART OR KIT. NOTE: PLEASE DO NOT CONFUSE Factory Direct Supply Co. WITH THIS COMPANY. Factory Direct Supply Co. IS AN INDEPENDENT RESELLER OF QUALITY AMERICAN MADE PARTS, WHICH ALTHOUGH NOT MANUFACTURED BY THE ORIGINAL FAUCET MANUFACTURER, ARE PRECISION MADE AND TESTED FOR EXCELLENT CUSTOMER SATISFACTION