



Z1209

VERTICAL OFFSET SIPHON JET WATER CLOSET SUPPORT SYSTEM

SPECIFICATION SHEET

TAG _____

Dimensional Data (inches and [mm]) are Subject to Manufacturing Tolerances and Change Without Notice

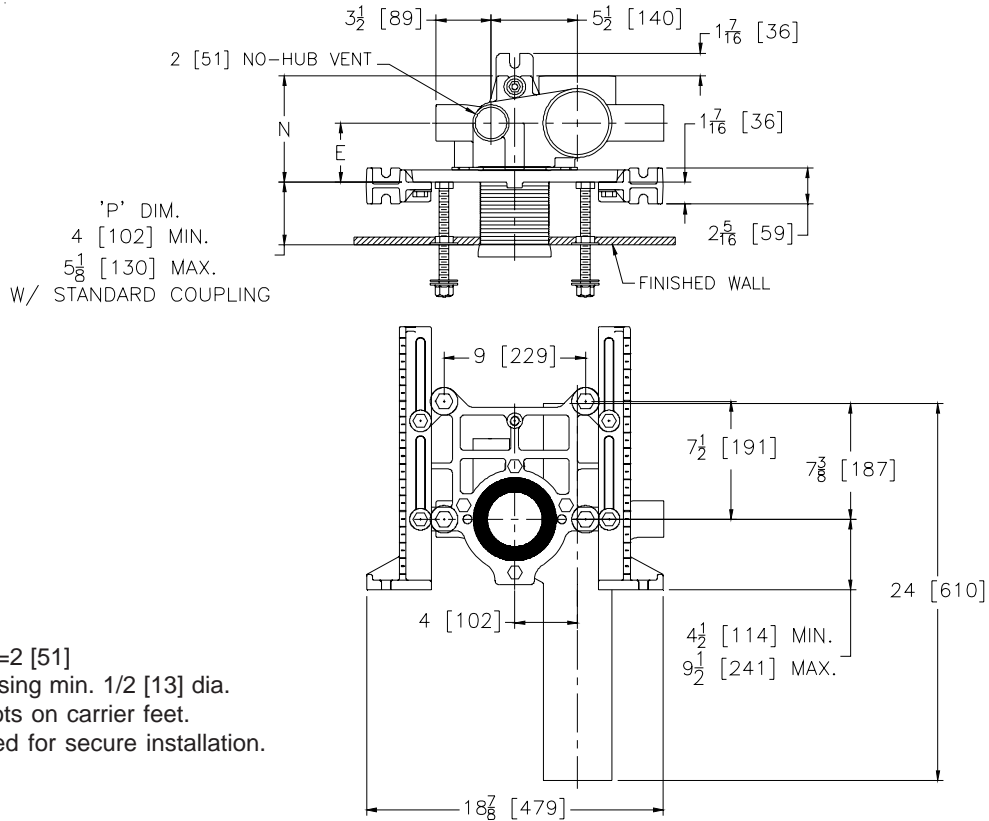

Note:

1. Min. 'P' Dim. Obtainable=2 [51]
2. Feet anchored to floor using min. 1/2 [13] dia. anchors through rear slots on carrier feet.
3. Rear anchor foot required for secure installation.

Product No.	Dimension In Inches		Approx. Wt. Lbs. [kg]
	E	N	
Z1209-NL4/NR4	3-3/4[95]	6-3/4[171]	67 [30]
Z1209-HL4/HR4	3-3/4[95]	6-3/4[171]	82 [37]

ENGINEERING SPECIFICATION: ZURNZ1209-()

Vertical Offset Siphon Jet Water Closet "Rigid System" with () size No-Hub or Hub and Spigot connections and 2 [51] vent. Complete with Dura-Coated cast iron main fitting, universal floor mounted foot supports, adjustable faceplate, corrosion resistant adjustable ABS coupling with integral test cap, fixture bolts, trim, and stud protectors. Rear anchor tie down, and bonded "Neo-Seal" gasket.

PRODUCT/DEFINITION

- ___ Z1209-NL4 4 [102] No-Hub Stack, Left Hand Offset Inlet, 2 [51] Left Hand Vent
- ___ Z1209-NR4 4 [102] No-Hub Stack, Right Hand Offset Inlet, 2 [51] Right Hand Vent
- ___ Z1209-HL4 4 [102] Hub & Spigot Stack, Left Hand Offset Inlet, 2 [51] Left Hand Vent
- ___ Z1209-HR4 4 [102] Hub & Spigot Stack, Right Hand Offset Inlet, 2 [51] Right Hand Vent

PREFIXES

- ___ Z D.C.C.I. System with Zurn "ZZ" Adjustable Coupling
- ___ ZQ D.C.C.I. System with N.P.T. Inlet, Non-Adjustable Coupling

SUFFIXES

- ___ -A Auxiliary Support Assembly (For P-Dim. greater than 18 [457])
- ___ -B Blowout Type Fixture Support
- ___ -CC Corrosion Resistant Cast Iron Coupling (6 [152] to 12 [305])
- ___ -CL Coupling Length Greater than 12 [305] (Specify length Required)
- ___ -F Floor Mounted, Back Outlet Fixture Support
- ___ -G Galvanized Cast Iron
- ___ -JJ Two 2 [51] Auxiliary Inlet
- ___ -JS Stack Side 2 [51] Auxiliary Inlet
- ___ -JV Vent Side 2 [51] Auxiliary Inlet
- ___ -M Auxiliary Foot Support (For P-Dim. 10 [254] to 18 [457])
- ___ -PF Pre-Fab Foot
- ___ -PS Pre-Fab Slotted Foot
- ___ -RYK Unistrut Pre-Fab Foot
- ___ -VP Vandal Proof Trim
- ___ -X3 3 [76] Carrier Foot Extension Assembly
- ___ -X4 4 [102] Carrier Foot Extension Assembly
- ___ -29 Mechanical Test Cap Assembly
- ___ -45 Finishing Frame for Siphon Jet System
- ___ -50 Flush Valve Supply Support for Water Closet
- ___ -61 Adjusting Wrench for "ZZ" Coupling

*REGULARLY FURNISHED UNLESS OTHERWISE SPECIFIED

REV. H	DATE: 04/20/11	C.N. NO. 121170
DWG. NO. 58844	PRODUCT NO. Z1209	