



Z166

VANDAL RESISTANT EMERGENCY OVERFLOW DRAIN

SPECIFICATION SHEET

TAG _____

Dimensional Data (inches and [mm]) are Subject to Manufacturing Tolerances and Changes Without Notice

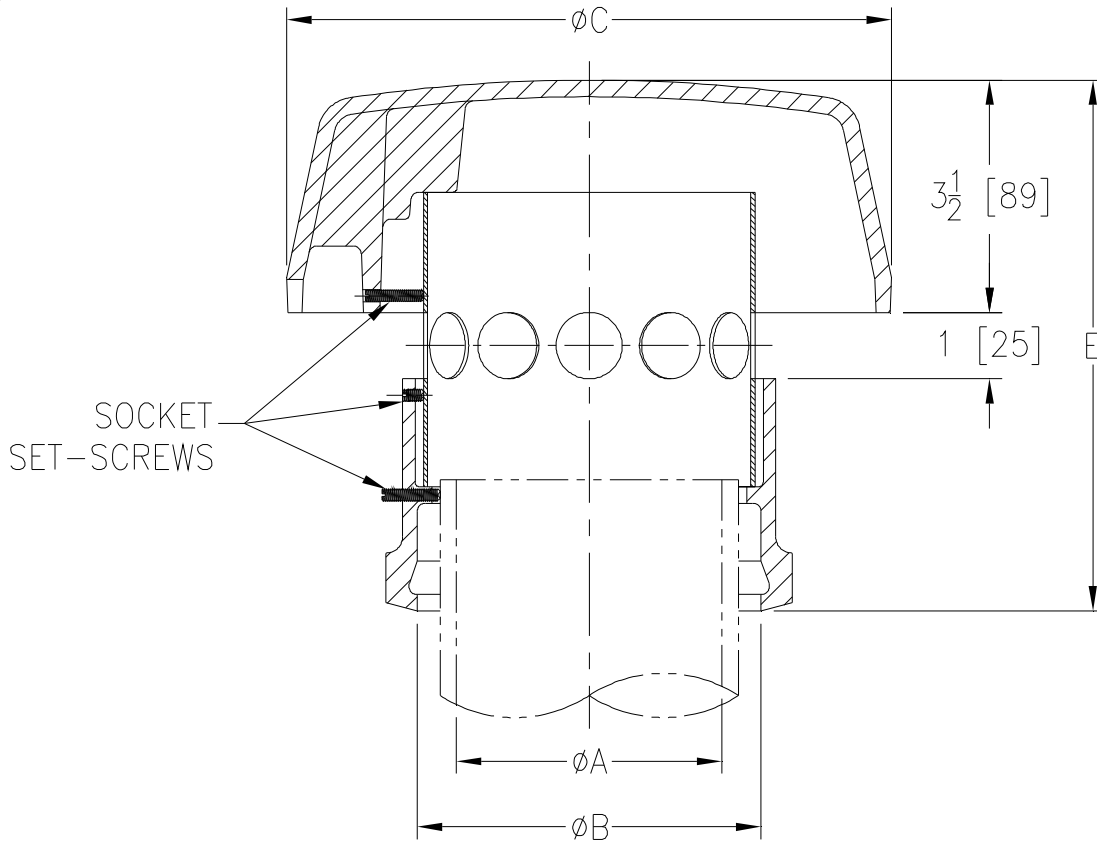

| A Pipe Size Inches | Dimensions In Inches | | Approx. Wt. Lbs. [kg] | Open Area Sq. In. [cm ²] |
|--------------------------|----------------------|--------------|-----------------------------|--|
| | B | C | | |
| 2 [51] | 3-1/16 [77] | 6-3/8 [162] | 9 [4] | 6.3 |
| 3 [76] | 4-3/16 [106] | 7-5/8 [194] | 12 [5] | 7.4 |
| 4 [102] | 5-3/16 [131] | 9-1/8 [232] | 14 [6] | 9.4 |
| 5 [127] | 6-3/16 [157] | 10-1/8 [257] | 16 [7] | 11.7 |
| 6 [152] | 7-3/16 [182] | 11-5/8 [295] | 18 [8] | 13.4 |

ENGINEERING SPECIFICATION: ZURN Z166 Vandal Resistant Emergency Overflow Drain. Dura-Coated cast iron body, dome cap, steel perforated overflow sleeve, and vandal-proof securing device.

OPTIONS (Check/specify appropriate options)

PIPE SIZE

2 thru 6 [51 thru 152]

(Specify size) **OUTLET**

___ IC Inside Caulk

'E' BODY HT. DIM.

8 [203]

PREFIXES

___ Z D.C.C.I. Body and Dome Cap*

SUFFIXES

___ -AR Acid Resistant Epoxy Coating Finish
___ -G Galvanized Cast Iron

| | | |
|----------------|------------------|-----------------|
| REV. B | DATE: 10/21/10 | C.N. NO. 111905 |
| DWG. NO. 82592 | PRODUCT NO. Z166 | |

*REGULARLY FURNISHED UNLESS OTHERWISE SPECIFIED