



# Z1727

## ADJUSTABLE FLOOR DRAIN MEDIUM-DUTY WITH SQUARE TOP

SPECIFICATION SHEET

TAG \_\_\_\_\_

Dimensional Data (inches and [ mm ]) are Subject to Manufacturing Tolerances and Change Without Notice

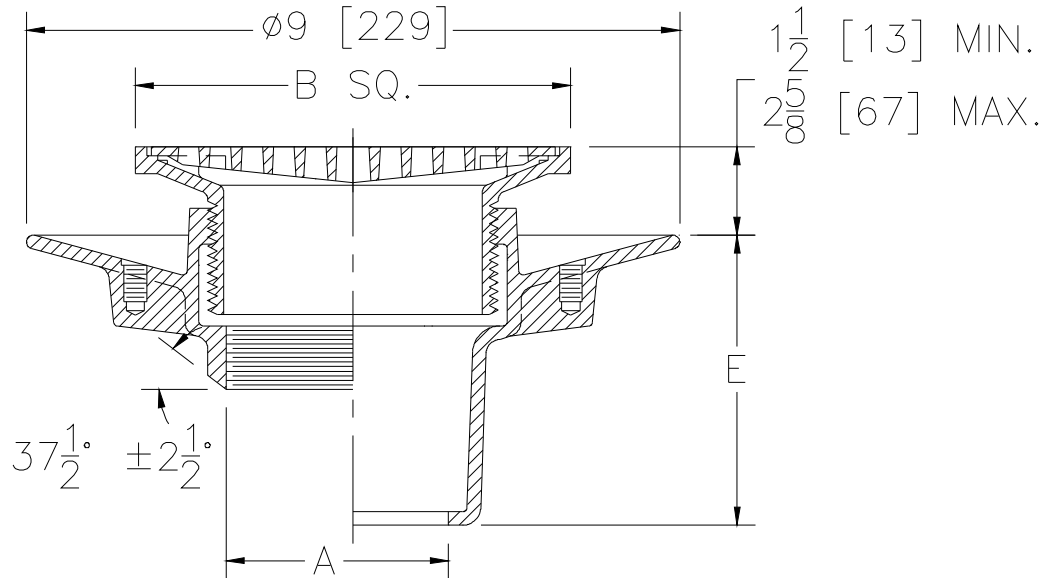

| A<br>Pipe Size     | Size<br>B         | Approx.<br>Wt. Lbs.<br>[kg] | Grate Open<br>Area<br>Sq. In. [cm <sup>2</sup> ] |
|--------------------|-------------------|-----------------------------|--|
| 2-3 [51-76]        | 5 X 5 [127 X 127] | 13 [6]                      | 9 [58]   |
| 2-3-4 [51-76-102]  | 6 X 6 [152 X 152] | 14 [6]                      | 13 [84]  |
| 3-4-6 [76-102-152] | 8 X 8 [203 X 203] | 18 [8]                      | 24 [155]   |

**ENGINEERING SPECIFICATION: ZURN Z1727**  
All Type 304 (CF8) stainless steel adjustable floor drain with anchor flange (clamp collar with seepage holes, when specified), and 6 [153] square medium-duty vertically adjustable satin finish top.

**OPTIONS** (Check/specify appropriate options)

**PIPE SIZE**

2-3-4-6 [51-76-102-152]

(Specify size/type) **OUTLET**

\_\_\_ BW Butt-weld  
(Specify Schedule 10, 40 or 80)  
\_\_\_ IC Inside Caulk  
\_\_\_ IP Threaded

**'E' BODY HT. DIM.**

2-7/8 [73]  
4-3/8 [111]  
2-7/8 [73]

**PREFIXES**

\_\_\_ Z Type 304 (CF8) Stainless Steel Body\*  
\_\_\_ ZM Type 316 (CF8M) Stainless Steel Body

**SUFFIXES**

\_\_\_ -K Seepage Holes Only  
\_\_\_ -KC Clamp Collar with Seepage Holes  
\_\_\_ -SG Solid Gasketed Cover  
\_\_\_ -SQ5 5 [127] Square Type 304 Stainless Steel Top  
\_\_\_ -SQ8 8 [203] Square Type 304 Stainless Steel Top  
\_\_\_ -V Bronze Backwater Valve  
\_\_\_ -VP Vandal-Proof Secured Top  
\_\_\_ -Y Stainless Steel Sediment Bucket

\* Regularly furnished unless otherwise specified.