



Z1740 BACKWATER VALVE

SPECIFICATION SHEET

TAG _____

Dimensional Data (inches and [mm]) are Subject to Manufacturing Tolerances and Change Without Notice

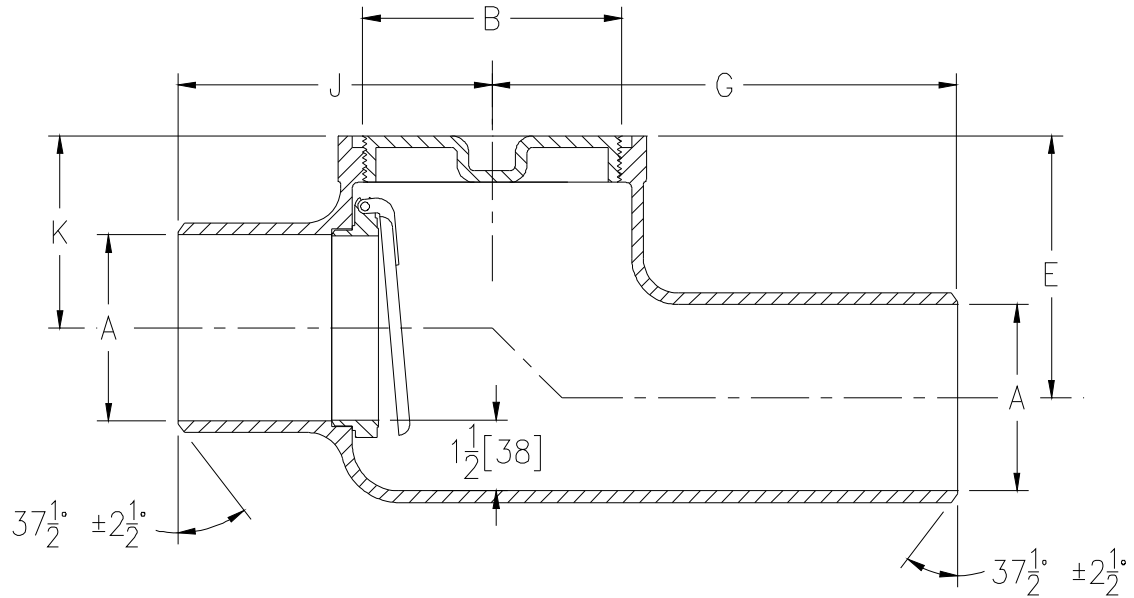

Dimensions in Inches						Approx. Wt. Lbs. [kg]
A-Pipe Size	B	E	G	J	K	
3 [76]	4-1/2 [114]	5-1/8 [130]	8 [203]	6 [152]	3-5/8 [92]	40 [18]
4 [102]	5 [127]	5-5/8 [143]	8-1/2 [216]	6-3/4 [171]	4-1/8 [105]	

ENGINEERING SPECIFICATION: ZURN Z1740 Backwater valve, Type 304 (CF8) stainless steel body with bronze backwater valve and bronze threaded cover.

OPTIONS (Check/specify appropriate options)

PIPE SIZE

3-4 [76-102]

(Specify size) **OUTLET**

_____ BW Butt-weld
(Specify Schedule 10, 40 or 80)

PREFIXES

- _____ Z Type 304 (CF8) Stainless Steel Body*
- _____ ZM Type 316 (CF8M) Stainless Steel Body

SUFFIXES

- _____ -SP Stainless Steel Threaded Cover
- _____ -SV Stainless Steel Backwater Valve

REV. E	DATE: 11/18/10	C.N. NO. 120400
DWG. NO. 59303		PRODUCT NO. Z1740

*REGULARLY FURNISHED UNLESS OTHERWISE SPECIFIED