



Z1910

8 X 8 [203 X 203] A.R.E. SANI-FLOR RECEPTOR 6 [152] SUMP DEPTH

SPECIFICATION SHEET

TAG _____

Dimensional Data (inches and [mm]) are Subject to Manufacturing Tolerances and Change Without Notice

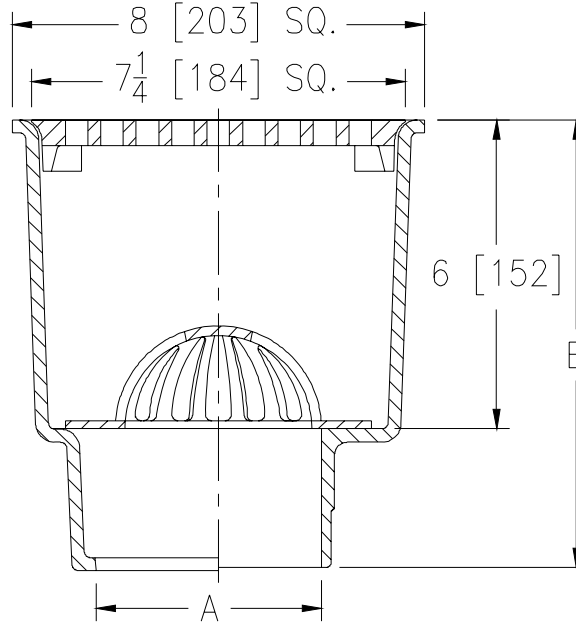

A Pipe Size In.	Approx Wt. Lbs. [kg]	Grate Open Area Sq. In. [cm ²]
2-3-4 [51-76-102]	25 [11]	19 [123]

ENGINEERING SPECIFICATION: ZURNZ1910

Sani-Flor Receptor 8 x 8 x 6 [203 x 203 x 152] deep cast iron body and square, medium-duty grate with 7/16 [11] slotted openings, white acid resisting porcelain enamel interior and top, complete with white ABS anti-splash interior bottom dome strainer.

OPTIONS (Check/specify appropriate options)

PIPE SIZE

2-3-4 [51-76-102]
2-3-4 [51-76-102]
2-3-4 [51-76-102]

(Specify size/type) OUTLET

___ IC Inside Caulk
___ NH No-Hub
___ NL Neo-Loc

'E' BODY HT. DIMENSION

Z	ZN
8-3/4 [222]	9-1/4 [235]
8-5/8 [219]	9-1/8 [232]
8 [203]	8-1/2 [216]

PREFIXES

___ Z Cast Iron Body with White A.R.E. Interior*
___ ZN Cast Iron Body with White A.R.E. Interior, 8-9/16 [217] Square N.B. Frame and Full Grate with 5/16 [8] Square Openings (Add 1/2 [13] to 8 [203] Dim.)

SUFFIXES

___ -DX Dex-O-Tex Flange (ZN Only)	___ -11 Vandal-Proof Secured Grate (ZN Only)
___ -K Anchor Flange	___ -12 Depressed Aluminum Grate (ZN Only)
___ -KC Anchor Flange with Seepage Holes and Clamp Collar	___ -15 Solid Loose Set Cover
___ -LD Less Bottom Dome Strainer	___ -16 1/2 Solid Loose Set Cover
___ -P 1/2 [13] Trap Primer Connection (See Z1023)	___ -17 3/4 Solid Loose Set Cover
___ -TC Neo-Loc Test Cap Gasket (2 - 4 [51 - 102] NL Bottom Outlet Only)	___ -18 Solid Loose Set Cover with Square Center Opening
___ -1 Less Grate	___ -19 Full Hinged Grate (ZN Only)
___ -2 1/2 Grate	___ -23 Aluminum Bucket
___ -3 3/4 Grate	___ -25 White A.R.C. Bucket
___ -4 Full Grate with Square Center Opening	___ -31 Stainless Steel Mesh Liner for Bucket
___ -5 Grate w/ 4 [102] Dia. x 3-3/4 [95] High Funnel	___ -32 Aluminum Dome Strainer
___ -6 Grate w/ 6 [152] Dia. x 6 [152] High Funnel	___ -33 White A.R.C. Anti-Splash Bottom Dome Strainer
___ -7 Grate w/ 6-3/4 x 3 x 1 [171 x 76 x 25] High Oval Funnel	
___ -8 Grate w/ 8-7/8 x 3-5/8 x 3-3/4 [225 x 92 x 95] High Oval Funnel	

*REGULARLY FURNISHED UNLESS OTHERWISE SPECIFIED

REV. H DATE: 10/19/11 C.N. NO. 122304

DWG. NO. 59344

PRODUCT NO. Z1910