



Z415D

BODY ASSEMBLY W/ "TYPE D" STRAINER

SPECIFICATION SHEET

TAG _____

Dimensional Data (inches and [mm]) are Subject to Manufacturing Tolerances and Change Without Notice

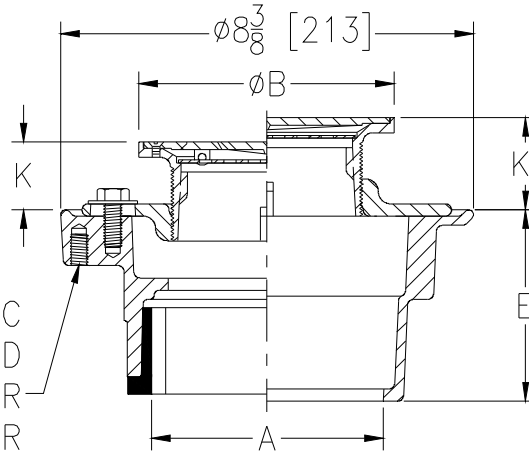

FOUR 3/8-16 NC
TAPPINGS PROVIDED
ON UNDERSIDE FOR
-SA, -SQ, AND -SR
SUFFIX OPTIONS ONLY

Dimensions In Inches						Approx. Wt. Lbs. [kg]
A - Pipe Size	B Strainer Dia.	K		K'		
		Min.	Max.	Min.	Max.	
2-3 [51-76]	5 [127]	1 [25]	1-1/2 [38]	1-3/32 [28]	2-1/4 [57]	12 [5]
2-3-4 [51-76-102]	6 [152]	1 [25]	1-25/32 [45]	1-13/32 [36]	2-17/32 [64]	14 [6]
2-3-4 [51-76-102]	7 [178]	1 [25]	2-1/8 [54]	1-23/32 [44]	2-7/8 [73]	15 [7]
3-4 [76-102]	8 [203]	1-5/32 [29]	2-1/8 [54]	1-3/4 [44]	2-7/8 [73]	17 [8]
6 [152]	8 [203]	1-5/32 [29]	2-1/8 [54]	1-3/4 [51]	2-7/8 [73]	19 [89]

ENGINEERING SPECIFICATION: ZURNZN415D

Floor and shower drain, Dura-Coated cast iron body with bottom outlet, combination invertible membrane clamp and adjustable collar with seepage slots and "TYPE D" polished, hinged solid, nickel bronze, light-duty strainer.

OPTIONS (Check/specify appropriate options)

PIPE SIZE

- 2 thru 4 [51 thru 102]
- 2 thru 4 [51 thru 102]
- 2 [51]
- 3 [76]
- 4 [102]
- 6 [152]
- 2 thru 4 [51 thru 102]
- 2 thru 4 [51 thru 102]

(Specify size/type) **OUTLET**

- _____ IC Inside Caulk
- _____ IG Inside Gasket
- _____ IP Threaded
- _____ IP Threaded
- _____ IP Threaded
- _____ IP Threaded
- _____ NH No-Hub
- _____ NL Neo-Loc

'E' BODY HT. DIM.

- 3-7/8 [98]
- 3-7/8 [98]
- 2-3/8 [60]
- 2-5/8 [67]
- 2-7/8 [73]
- 2-3/4 [70]
- 3-7/8 [98]
- 3-3/4 [95]

PREFIXES

- _____ ZB D.C.C.I. Body Assembly w/ Polished Bronze Top
- _____ ZN D.C.C.I. Body Assembly w/ Polished Nickel Bronze Top*

SUFFIXES

- | | |
|--|---|
| <ul style="list-style-type: none"> _____ -AR Acid Resisting Epoxy Coated Cast Iron _____ -CP Chrome-Plated Bronze Top _____ -G Galvanized Cast Iron _____ -P Trap Primer Connection (Specify 1/2 [13] or 3/4 [19]) _____ -SA Stabilizer Assembly (See Z1035) _____ -SQ Stabilizer Q-Deck (See Z1035-Q) _____ -SR Stabilizer Ring _____ -TC Neo-Loc Test Cap Gasket
(2 - 4 [51 - 102] NL Bottom Outlet Only) _____ -U 1 - 3 [25 - 76] High Extension Adapter | <ul style="list-style-type: none"> _____ -V Backwater Valve _____ -VP Vandal-Proof Secured Top _____ -Y Sediment Bucket _____ -18 Leveling Ring (See Z400-18) _____ -90 90° Threaded Side Outlet Body
Assembly (2 [51], 3 [76] Only) |
|--|---|

*REGULARLY FURNISHED UNLESS OTHERWISE SPECIFIED

REV. L	DATE: 06/21/11	C.N. NO. 121444
DWG. NO. 58792	PRODUCT NO. Z415D	

ZURN INDUSTRIES, LLC ♦ SPECIFICATION DRAINAGE OPERATION ♦ 1801 Pittsburgh Ave. ♦ Erie, PA 16514

Phone: 814/455-0921 ♦ Fax: 814/454-7929 ♦ World Wide Web: www.zurn.com

In Canada: ZURN INDUSTRIES LIMITED ♦ 3544 Nashua Drive ♦ Mississauga, Ontario L4V1L2 ♦ Phone: 905/405-8272 Fax: 905/405-1292