



# Z415J

## BODY ASSEMBLY W/ "TYPE J" HEEL-PROOF STRAINER

SPECIFICATION SHEET

TAG \_\_\_\_\_

Dimensional Data (inches and [ mm ]) are Subject to Manufacturing Tolerances and Change Without Notice

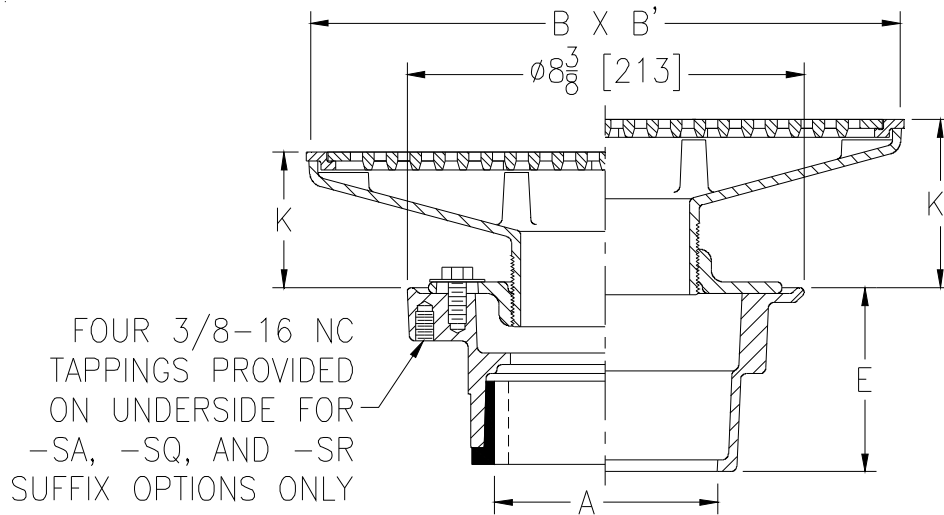

Dimensions In Inches						Approx. Wt. Lbs. [kg]	Strainer Open Area Sq. In. [cm <sup>2</sup> ]
A - Pipe Size	B x B' Strainer Size	K		K'			
		Min.	Max.	Min.	Max.		
2-3-4 [51-76-102]	4-1/2 x 8 [114 x 203]	1-3/8 [35]	2-5/8 [67]	2-1/8 [54]	3-3/8 [86]	13 [6]	12 [72]
2-3-4 [51-76-102]	5 x 9 [127 x 229]	1-5/8 [41]	2-13/16 [71]	2-3/8 [60]	3-5/8 [92]	14 [6]	15 [97]
3-4 [76-102]	5-1/2 x 13 [140 x 330]	2-3/32 [51]	3-5/16 [84]	2-13/16 [71]	4 [102]	18 [8]	20 [129]
3-4 [76-102]	5 x 17 [127 x 432]	2-1/4 [57]	3-5/16 [84]	2-13/16 [71]	4 [102]	23 [10]	29 [187]
3-4 [76-102]	5 x 21 [127 x 533]	2-5/16 [59]	3-5/16 [84]	2-13/16 [71]	4 [102]	27 [12]	32 [206]
6 [152]	10 x 20 [254 x 508]	2-9/16 [65]	3-1/4 [83]	2-7/8 [73]	4 [102]	45 [20]	66 [426]

### ENGINEERING SPECIFICATION: ZURNZN415J

Floor and shower drain, Dura-Coated cast iron body with bottom outlet, combination invertible membrane clamp and adjustable collar with seepage slots and "TYPE J" polished, nickel bronze rectangular, light-duty, heel-proof strainer.

### OPTIONS (Check/specify appropriate options)

#### PIPE SIZE

2 thru 4 [51 thru 102]  
2 thru 4 [51 thru 102]  
2 [51]  
3 [76]  
4 [102]  
6 [152]  
2 thru 4 [51 thru 102]  
2 thru 4 [51 thru 102]

#### (Specify size/type) OUTLET

\_\_\_\_\_ IC Inside Caulk  
\_\_\_\_\_ IG Inside Gasket  
\_\_\_\_\_ IP Threaded  
\_\_\_\_\_ IP Threaded  
\_\_\_\_\_ IP Threaded  
\_\_\_\_\_ IP Threaded  
\_\_\_\_\_ NH No-Hub  
\_\_\_\_\_ NL Neo-Loc

#### 'E' BODY HT. DIM.

3-7/8 [98]  
3-7/8 [98]  
2-3/8 [60]  
2-5/8 [67]  
2-7/8 [73]  
2-3/4 [70]  
3-7/8 [98]  
3-3/4 [95]

#### PREFIXES

\_\_\_\_\_ ZB D.C.C.I. Body Assembly w/ Polished Bronze Top  
\_\_\_\_\_ ZN D.C.C.I. Body Assembly w/ Polished Nickel Bronze Top\*

#### SUFFIXES

\_\_\_\_\_ -AR Acid Resisting Epoxy Coated Cast Iron  
\_\_\_\_\_ -G Galvanized Cast Iron  
\_\_\_\_\_ -P Trap Primer Connection (Specify 1/2 [13] or 3/4 [19])  
\_\_\_\_\_ -SA Stabilizer Assembly (See Z1035)  
\_\_\_\_\_ -SQ Stabilizer Q-Deck (See Z1035-Q)  
\_\_\_\_\_ -SR Stabilizer Ring  
\_\_\_\_\_ -TC Neo-Loc Test Cap Gasket  
(2 - 4 [51 - 76] NL Bottom Outlet Only)

\_\_\_\_\_ -U 1 - 3 [25 - 76] High Extension Adapter  
\_\_\_\_\_ -V Backwater Valve  
\_\_\_\_\_ -VP Vandal-Proof Secured Top  
\_\_\_\_\_ -Y Sediment Bucket  
\_\_\_\_\_ -18 Leveling Ring (See Z400-18)  
\_\_\_\_\_ -90 90° Threaded Side Outlet Body Assembly (2 [51], 3 [76] Only)

\*REGULARLY FURNISHED UNLESS OTHERWISE SPECIFIED

REV. K DATE: 10/18/11 C.N. NO. 122287

DWG. NO. 58798

PRODUCT NO. Z415J