



Z415T

BODY ASSEMBLY W/ "TYPE T" STRAINER

SPECIFICATION SHEET

TAG _____

Dimensional Data (inches and [mm]) are Subject to Manufacturing Tolerances and Change Without Notice

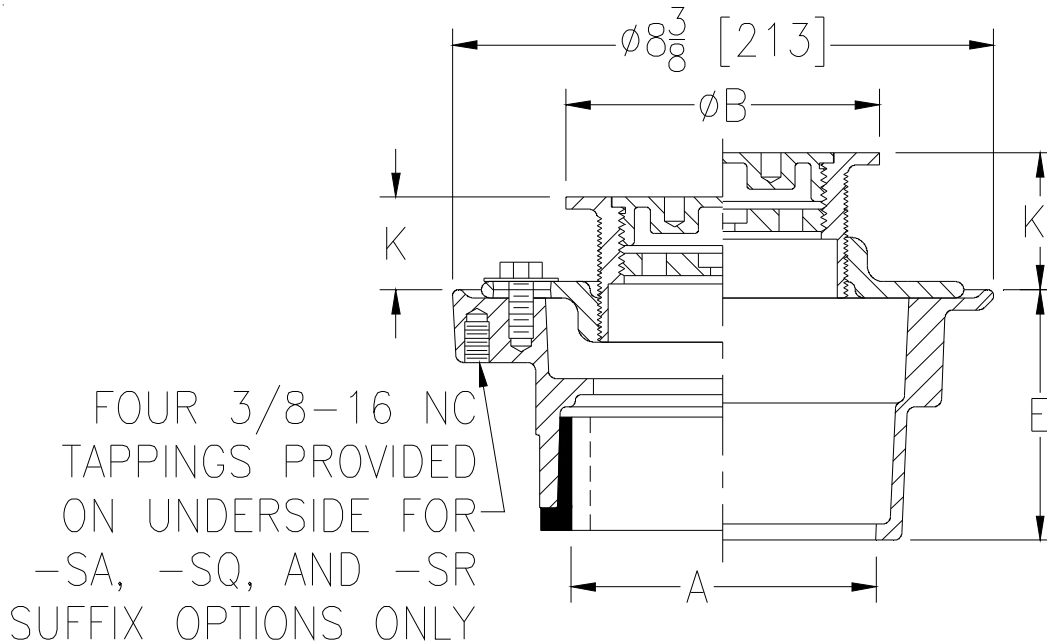

Dimensions In Inches						Approx. Wt. Lbs. [kg]	Strainer Open Area Sq. In. [cm ²]
A - Pipe Size	B - Dia.	K		K'			
		Min.	Max.	Min.	Max.		
2-3 [51-76]	5 [127]	1 [25]	1-7/8 [48]	1 [25]	2-5/8 [67]	12 [5]	6 [39]
2-3-4 [51-76-102]	6 [152]	1-1/4 [32]	2-1/16 [52]	2 [51]	2-13/16 [71]	13 [6]	7 [45]
2-3-4 [51-76-102]	7 [178]	1-1/4 [32]	2-1/16 [52]	2 [51]	2-13/16 [71]	14 [6]	7 [45]

ENGINEERING SPECIFICATION: ZURN ZN415T

Floor and shower drain, Dura-Coated cast iron body with bottom outlet, combination invertible membrane clamp and adjustable collar with seepage slots and "TYPE T" polished nickel bronze strainer with solid, secured, light-duty cover.

OPTIONS (Check/specify appropriate options)

PIPE SIZE	(Specify size/type)	OUTLET	'E' BODY HT. DIM.
2 thru 4 [51 thru 102]	_____	IC Inside Caulk	3-7/8 [98]
2 thru 4 [51 thru 102]	_____	IG Inside Gasket	3-7/8 [98]
2 [51]	_____	IP Threaded	2-3/8 [60]
3 [76]	_____	IP Threaded	2-5/8 [67]
4 [102]	_____	IP Threaded	2-7/8 [73]
2 thru 4 [51 thru 102]	_____	NH No-Hub	3-7/8 [98]
2 thru 4 [51 thru 102]	_____	NL Neo-Loc	3-3/4 [95]

PREFIXES

- _____ ZB D.C.C.I. Body Assembly w/ Polished Bronze Top
- _____ ZN D.C.C.I. Body Assembly w/ Polished Nickel Bronze Top*

SUFFIXES

- | | |
|--|--|
| _____ -AR Acid Resisting Epoxy Coated Cast Iron | _____ -U 1-3 [25-76] High Extension Adapter |
| _____ -G Galvanized Cast Iron | _____ -18 Leveling Ring (See Z400-18) |
| _____ -P Trap Primer Connection (Specify 1/2 [13] or 3/4 [19]) | _____ -90 90° Threaded Side Outlet Body Assembly (2 [51], 3 [76] Only) |
| _____ -SA Stabilizer Assembly (See Z1035) | |
| _____ -SQ Stabilizer Q-Deck (See Z1035-Q) | |
| _____ -SR Stabilizer Ring | |
| _____ -SW Spanner Wrench for Cover | |

*REGULARLY FURNISHED UNLESS OTHERWISE SPECIFIED

REV. K	DATE: 06/21/11	C.N. NO. 121459
DWG. NO. 58806	PRODUCT NO. Z415T	