



Z546

21-1/2 [546] DIAMETER EXTRA-HEAVY-DUTY DRAIN

SPECIFICATION SHEET

TAG _____

Dimensional Data (inches and [mm]) are Subject to Manufacturing Tolerances and Change Without Notice

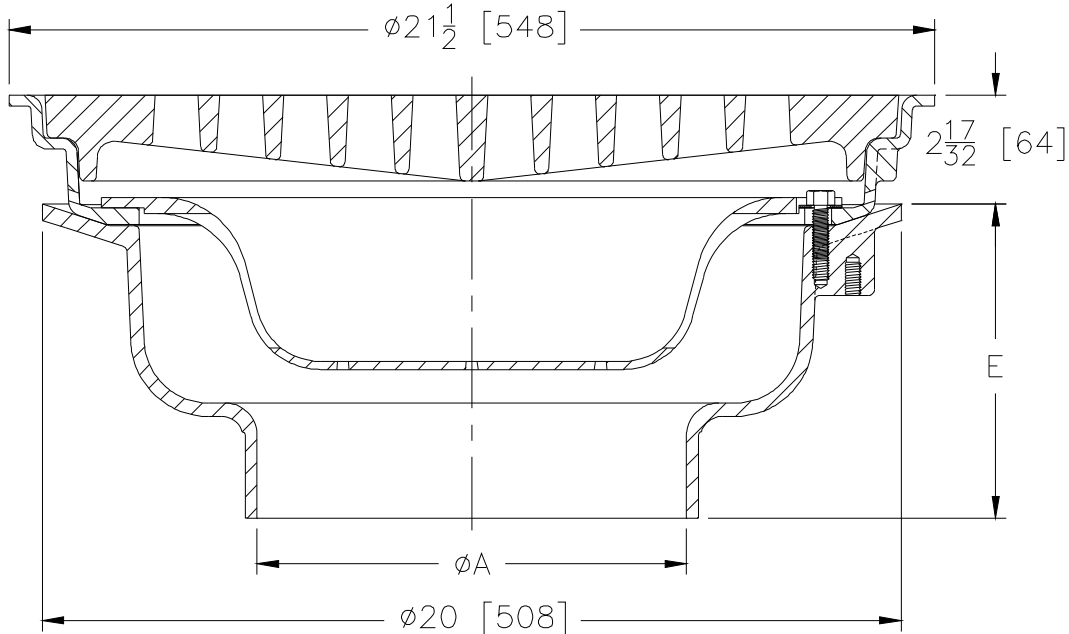

A - Pipe Size	Approx. Wt. Lbs. [kg]	Grate Open Area Sq. In. [cm ²]
8-10-12 [203-254-305]	163 [74]	110 [710]

ENGINEERING SPECIFICATION: ZURN Z546

21-1/2 [546] Diameter top drain, Dura-Coated cast iron body with bottom outlet, seepage pan and combination membrane flashing clamp and frame with seepage holes, extra-heavy-duty cast iron slotted grate with suspended sediment bucket.

OPTIONS (Check/specify appropriate options)

PIPE SIZE

8-10-12 [203 - 254 - 305]

(Specify size/type) **OUTLET**

___ NH No-Hub

'E' BODY HT. DIM.

7-5/16 [186]

PREFIXES

___ Z D.C.C.I. Body and Top*

SUFFIXES

- ___ -DG Duresist Grate
- ___ -F Extension Frame (Specify total height req'd.)
- ___ -G Galvanized Cast Iron
- ___ -LY Less Sediment Bucket
- ___ -TS Top Secured with Slotted Screws
- ___ -VP Vandal-Proof Secured Top

REV. D	DATE: 11/16/10	C.N. NO. 120435
DWG. NO. 82138	PRODUCT NO. Z546	

*REGULARLY FURNISHED UNLESS OTHERWISE SPECIFIED